

**THE TOUGHEST
RODENT BARRIERS**



... YOUR FIRST LINE OF DEFENSE

READY-TO-USE (RTU)

FOR REGULAR DOORS

INSTRUCTION MANUAL

1

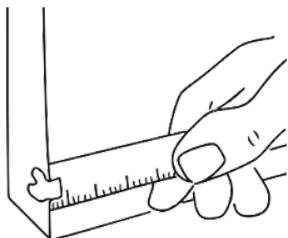

MEASURE THE DOOR.

2

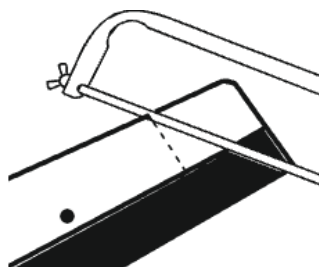

**CUT ACCORDING TO
MEASUREMENT.**

3



**PUSH THE SEAL SNUGLY INTO
THE ALUMINUM CARRIER.**

4

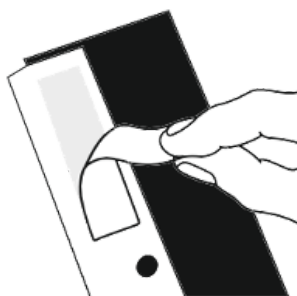

PEEL BACKING OFF THE TAPE.

5

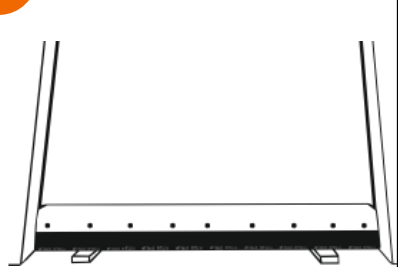

PLACE SEAL ON THE DOOR.

6

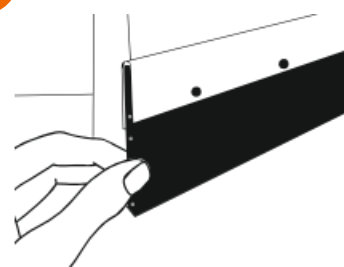

**ADJUST SEAL TO THE
SURFACE.**

7

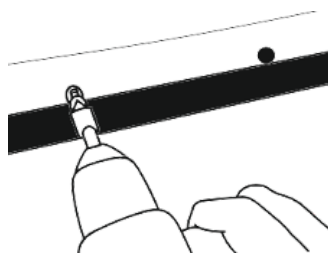

**ATTACH WITH SCREWS OR
RIVETS**

**THE TOUGHEST
RODENT BARRIERS**



... YOUR FIRST LINE OF DEFENSE

RAXIT QUICK

FOR REGULAR DOORS

INSTRUCTION MANUAL

1

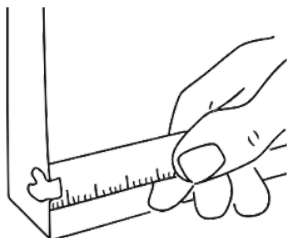

MEASURE THE DOOR.

2

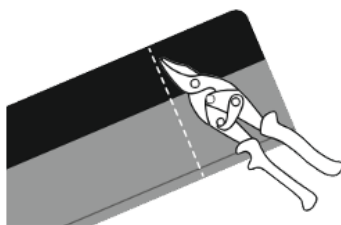

**CUT ACCORDING TO
MEASUREMENT.**

3

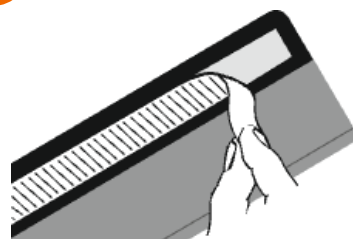

**PEEL BACKING OFF THE
DOUBLE SIDED TAPE.**

4



PLACE SEAL ON THE DOOR.

5

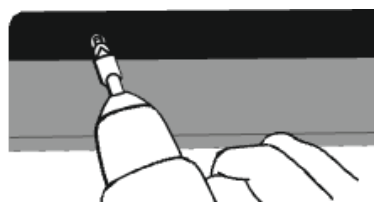

**ATTACHING WITH SCREWS IS OPTIONAL,
BUT RECOMMENDED FOR FREQUENTLY
USED DOORS OR IF THE SEAL IS
INSTALLED ON THE EXTERIOR SIDE OF
THE DOOR.**



**RAXIT QUICK PRODUCTS ARE SELF-ADHESIVE,
MAKING THEM IDEAL RODENT BARRIERS FOR
GLASS DOORS, FIRE DOORS, FREEZER DOORS, AND
MORE.**

**THE TOUGHEST
RODENT BARRIERS**



... YOUR FIRST LINE OF DEFENSE

RAXWOOL

PRO VERSION

INSTRUCTION MANUAL

1

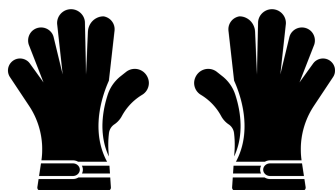

WEAR SAFETY GLOVES.

2

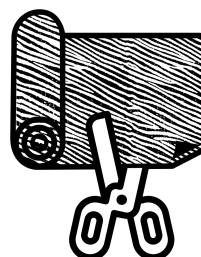

**CUT RAXWOOL TO THE
REQUIRED SIZE FOR THE
GAP, CRACK, OR HOLE.**

3

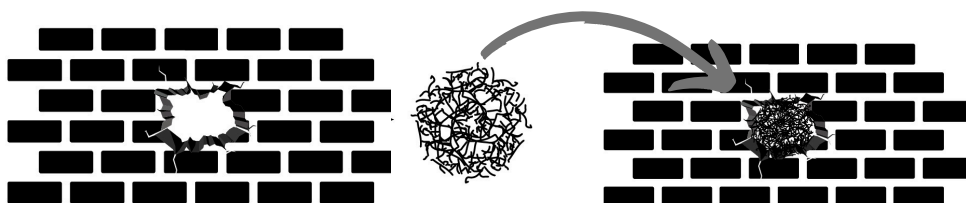

**INSERT RAXWOOL TO CREATE AN INSTANT
RODENT BARRIER.**

**THE TOUGHEST
RODENT BARRIERS**



... YOUR FIRST LINE OF DEFENSE

RAXWOOL

REGULAR VERSION

INSTRUCTION MANUAL

1

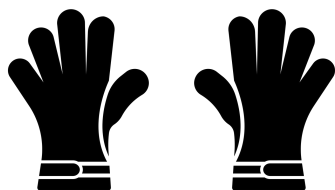

WEAR SAFETY GLOVES.

2

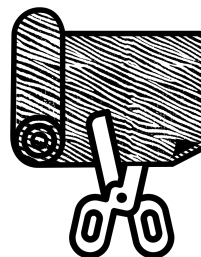

**CUT RAXWOOL TO THE
REQUIRED SIZE FOR THE
GAP, CRACK, OR HOLE.**

3

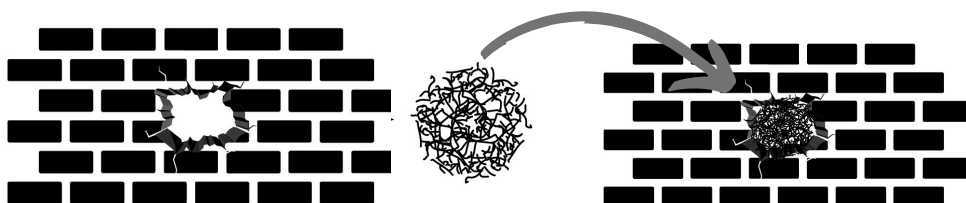

**INSERT RAXWOOL TO CREATE AN INSTANT
RODENT BARRIER.**

